

Towers Wills

Town & Country

📞 01935 577 032 | 01460 298 530 | ✉ info@towerswills.co.uk



6, Alexandra Road, Yeovil, Somerset BA21 5AL

£170,000

Towers Wills are delighted to present to the market this well-proportioned and generously sized two-bedroom mid-terrace home, situated in a convenient residential location on the edge of Yeovil. The property enjoys great access to local amenities, schools and commuter routes to both Yeovil and Sherborne, making it an excellent choice for a wide range of purchasers.

Accommodation:

Presented in excellent order throughout, the accommodation offers a welcoming lounge, separate dining room and fitted kitchen. The dining room provides access to a useful conservatory, creating additional reception space and leading through to a practical utility area.

To the first floor are two generous double bedrooms, both served by a well-appointed family bathroom.

Outside:

Outside, the rear garden has been designed with ease of maintenance in mind, being predominantly laid to gravel and lawn. A garden shed is positioned to one corner, while gated rear access adds further convenience.

This attractive home is ideally suited to a variety of buyers, including first-time purchasers looking to make a property their own, as well as buy-to-let investors. An internal viewing is highly recommended to fully appreciate the space and potential on offer.

Key Features

- Terraced House
- Two Bedrooms
- Within Walking Distance of the Town Centre/Hospital
- Rear Garden
- NO ONWARD CHAIN

Contact Us

Towers Wills Estate Agents - Yeovil

114, Hendford Hill
Yeovil

Somerset
BA202RF

T: 01935 577032

E: info@towerswills.co.uk



Floor Plan

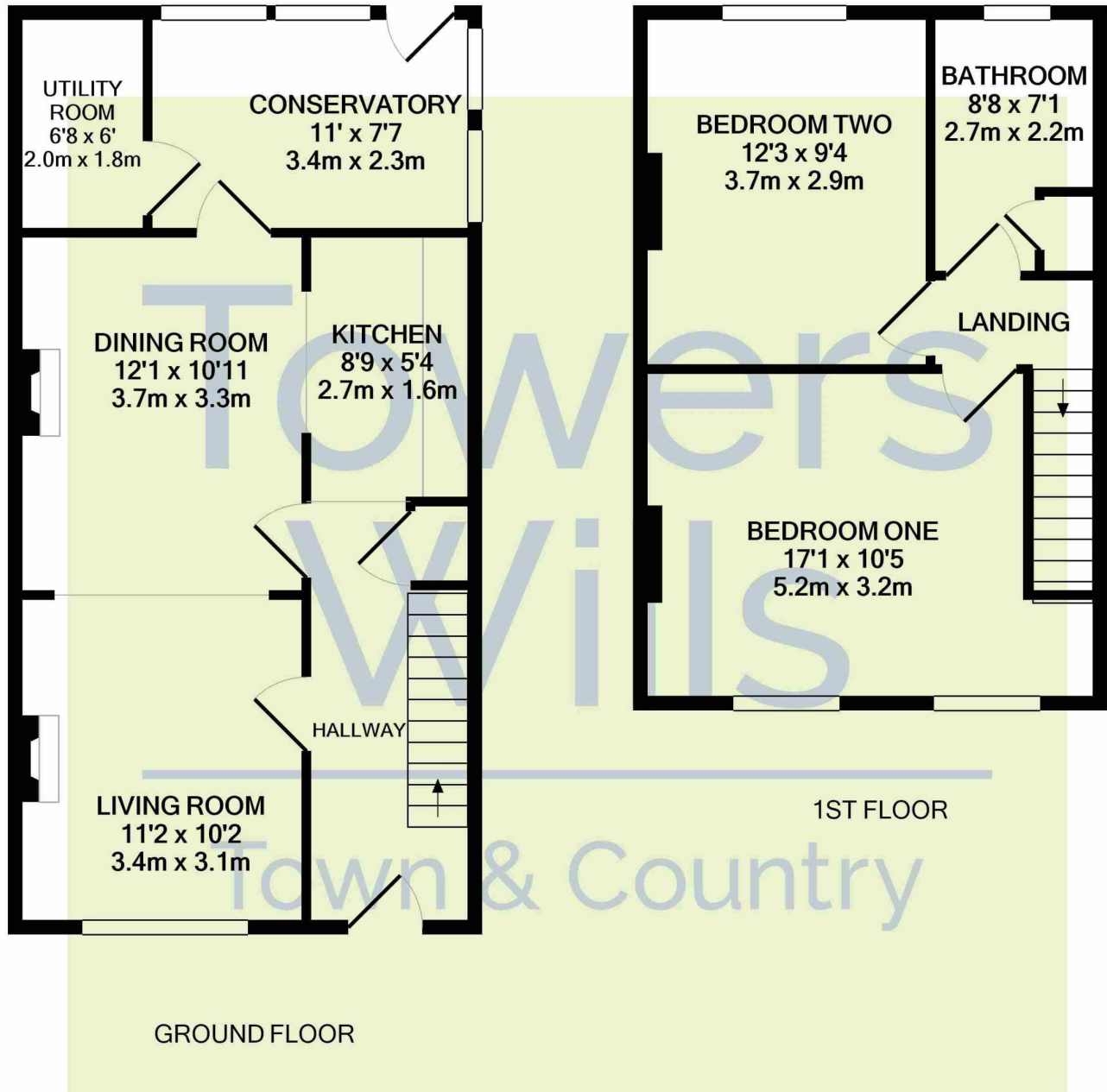

Whilst every attempt has been made to ensure the accuracy of the floor plan contained here, measurements of doors, windows, rooms and any other items are approximate and no responsibility is taken for any error, omission, or mis-statement. This plan is for illustrative purposes only and should be used as such by any prospective purchaser. The services, systems and appliances shown have not been tested and no guarantee as to their operability or efficiency can be given
Made with Metropix ©2020

Please Note No tests have been undertaken of any of the services and any intending purchasers should satisfy themselves in this regard. Towers Wills Ltd for themselves and for the vendor of this property whose agents they are, give notice that, (i) these particulars do not constitute any part of an offer or contract, (ii) all statements contained within these particulars are made without responsibility on the part of Towers Wills or the vendor, (iii) whilst made in good faith, none of the statements contained within these particulars are to be relied upon as a statement of representation or fact, (iv) any intending purchaser must satisfy him/herself by inspection or otherwise as to the correctness of each of the statements contained within these particulars, (v) the vendor does not make or give either Towers Wills or any person in their employment any authority to make or give representation or warranty whatsoever in relation to this property.

Photographs / Floor Plans Photographs are reproduced for general information and it must not be inferred that any item is included for sale with this property. Please note floor plans are not to scale and are for identification purposes only. The photographs used in these particulars may have been taken with the use of a wide angle lens. If you have any queries as to the size of the accommodation or plot, please address these with the agent prior to making an appointment to view

Towers Wills

The White House, 114 Hendford Hill, Yeovil BA20 2RF

Yeovil 01935 577032 / South Petherton 01460 298530

info@towerswills.co.uk | www.towerswills.co.uk