

Towers Wills

Town & Country

📞 01935 577 032 | 01460 298 530 | ✉ info@towerswills.co.uk



21, Lyde Road, Yeovil, Somerset BA21 5AT

£200,000

An ideal family home or buy to let! This four bed Victorian mid-terrace offers much in terms of size and space benefiting from a loft conversion/fourth bedroom, family bathroom, downstairs lounge, dining room, kitchen, utility/downstairs WC and off-road parking within the double garage to the rear. Please contact Towers Wills to arrange a viewing.

Entrance

Double glazed door to the front.

Lounge

Double glazed window to the front and radiator.

Dining Room

Double glazed window to the rear and radiator.

Kitchen

Fitted with a range of wall, base and drawer units, work surfacing with one and a half bowl stainless steel sink drainer, space for fridge freezer, dishwasher, integrated five ring gas hob with cookerhood over, integrated double electric oven, double glazed window to the side and double glazed door to the side.

W.C/Cloakroom

Double glazed window to the rear, w.c, wash hand basin, radiator and space for washing machine.

First Floor Landing

Radiator.

Bedroom Two

Double glazed window to the rear and radiator.

Bedroom Three

Double glazed window to the front and radiator.

Bedroom Four

Double glazed window to the front and radiator.

Second Floor Landing

Bedroom One

With double glazed windows to front and rear and radiator. The room has restricted head height and is of irregular shape.

Outside

To the front of the property the garden is laid to lawn.

Rear Garden

To the rear the garden is laid to AstroTurf with outside tap and summerhouse which leads to the double garage at the back via some double glazed French patio doors and there is a double glazed window to the rear garden, from the garage.

Double Garage

Has power, light and electric roller door.

Key Features

- **DOUBLE GARAGE**
- **Four bedrooms**
- **Spacious family home**
- **Walking distance to Penn Mill Train Station**
- **Cloak W.C**

Contact Us

Towers Wills Estate Agents - Yeovil

114, Hendford Hill

Yeovil

Somerset

BA202RF

T: 01935 577032

E: info@towerswills.co.uk

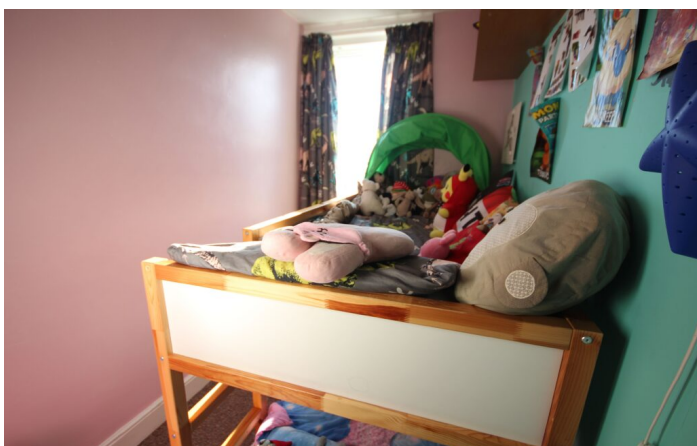

Floor Plan

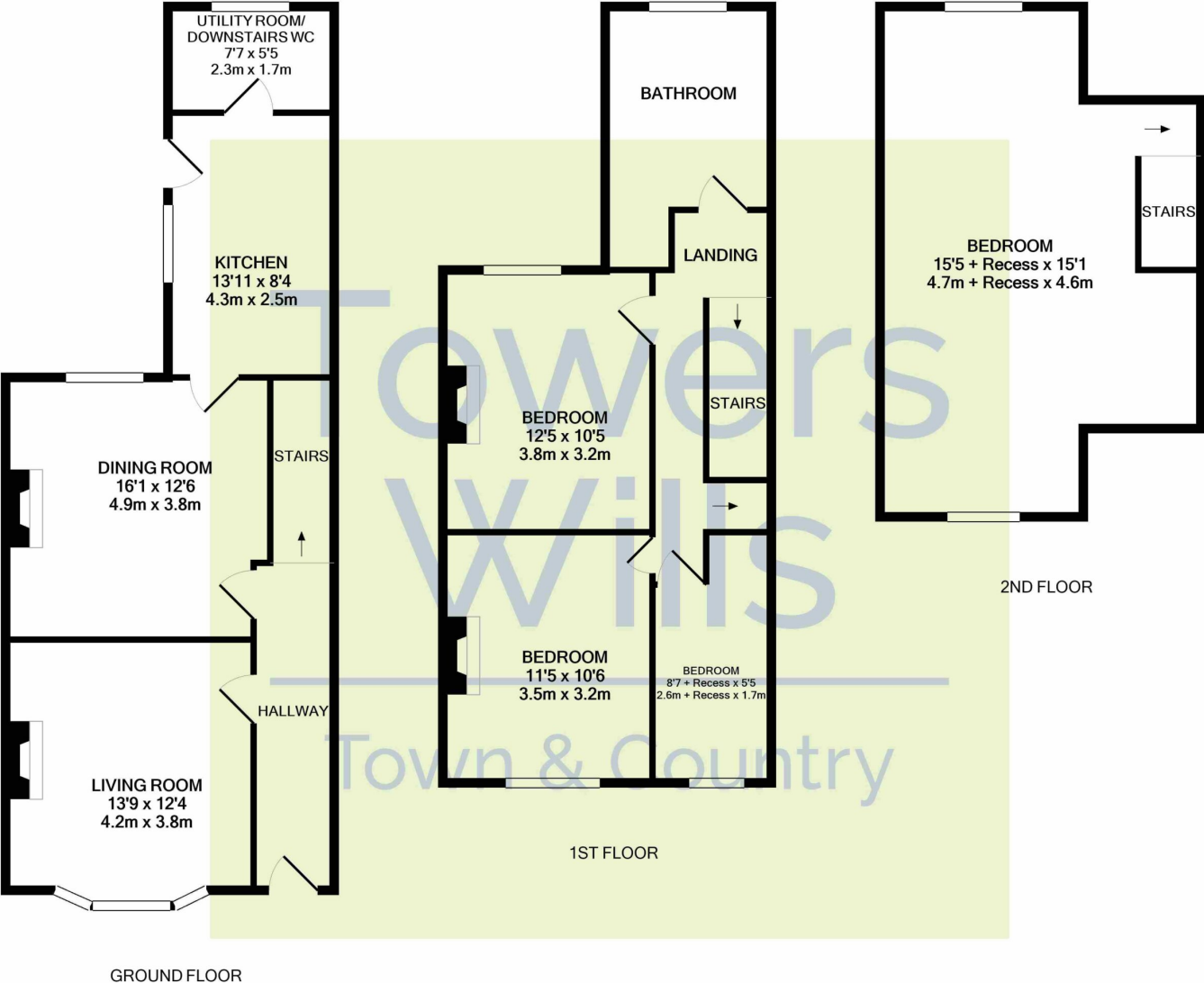

Whilst every attempt has been made to ensure the accuracy of the floor plan contained here, measurements of doors, windows, rooms and any other items are approximate and no responsibility is taken for any error, omission, or mis-statement. This plan is for illustrative purposes only and should be used as such by any prospective purchaser. The services, systems and appliances shown have not been tested and no guarantee as to their operability or efficiency can be given
Made with Metropix ©2021

Please Note No tests have been undertaken of any of the services and any intending purchasers should satisfy themselves in this regard. Towers Wills Ltd for themselves and for the vendor of this property whose agents they are, give notice that, (i) these particulars do not constitute any part of an offer or contract, (ii) all statements contained within these particulars are made without responsibility on the part of Towers Wills or the vendor, (iii) whilst made in good faith, none of the statements contained within these particulars are to be relied upon as a statement of representation or fact, (iv) any intending purchaser must satisfy him/herself by inspection or otherwise as to the correctness of each of the statements contained within these particulars, (v) the vendor does not make or give either Towers Wills or any person in their employment any authority to make or give representation or warranty whatsoever in relation to this property.

Photographs / Floor Plans Photographs are reproduced for general information and it must not be inferred that any item is included for sale with this property. Please note floor plans are not to scale and are for identification purposes only. The photographs used in these particulars may have been taken with the use of a wide angle lens. If you have any queries as to the size of the accommodation or plot, please address these with the agent prior to making an appointment to view