

# Towers Wills

Town & Country

📞 01935 577 032 | 01460 298 530 | ✉ info@towerswills.co.uk



**2, Brigadier Close, Yeovil, Somerset BA22 8SR**

**£240,000**

Towers Wills welcome to market this well-presented terraced home situated at the end of a quiet no through road on the popular western side of Yeovil. The property has delightful front and rear gardens, garage plus allocated parking space and inside; lounge, kitchen/diner, three bedrooms and a modern family bathroom. An ideal first time buy!

### Entrance Hall

Double glazed door to the front and radiator.

### Lounge 3.56m x 4.14m - maximum measurements

Double glazed window to the front, radiator and under stairs cupboard.

### Kitchen/Diner 3.08m x 4.54m - maximum measurements

Comprising of a range of wall, base and drawer units, work surfacing with one bowl carbon composite sink drainer, radiator, double glazed French doors to the rear, double glazed window to the rear, central heating boiler, space for washing machine, space for cooker which currently has a gas hob and double electric oven, cookerhood over and space for fridge freezer.

### First Floor Landing

Loft hatch.

### Bathroom

Suite comprising pear shape bath with shower over, wash hand basin, w.c, double glazed window to the front, heated towel rail, extractor fan, airing cupboard and shaver point.

### Bedroom One 3.60m x 2.64m - maximum measurements

Fitted wardrobes, radiator and double glazed window to the front.

### Bedroom Two 2.57m x 3.43m - maximum measurements

Radiator and double glazed window to the rear.

### Bedroom Three 2.55m x 1.90m

Radiator and double glazed window to the rear.

### Front Garden

The front garden is largely laid to lawn, enclosed by hedgerow, stone wall to the front and mature tree.

### Rear Garden

To the rear there is a lawn area, patio, outside tap, double glazed personal door leading to the garage and a corner patio/seating area.

### Single Garage

With 'up and over' door, power and light.

### Parking

To the rear of the property there is an allocated parking space.

## Key Features

- Terrace
- Three bedrooms
- Desirable location
- Garage and Parking
- In good condition throughout

## Contact Us

### Towers Wills Estate Agents - Yeovil

114, Hendford Hill

Yeovil

Somerset

BA202RF

T: 01935 577032

E: [info@towerswills.co.uk](mailto:info@towerswills.co.uk)





# Floor Plan

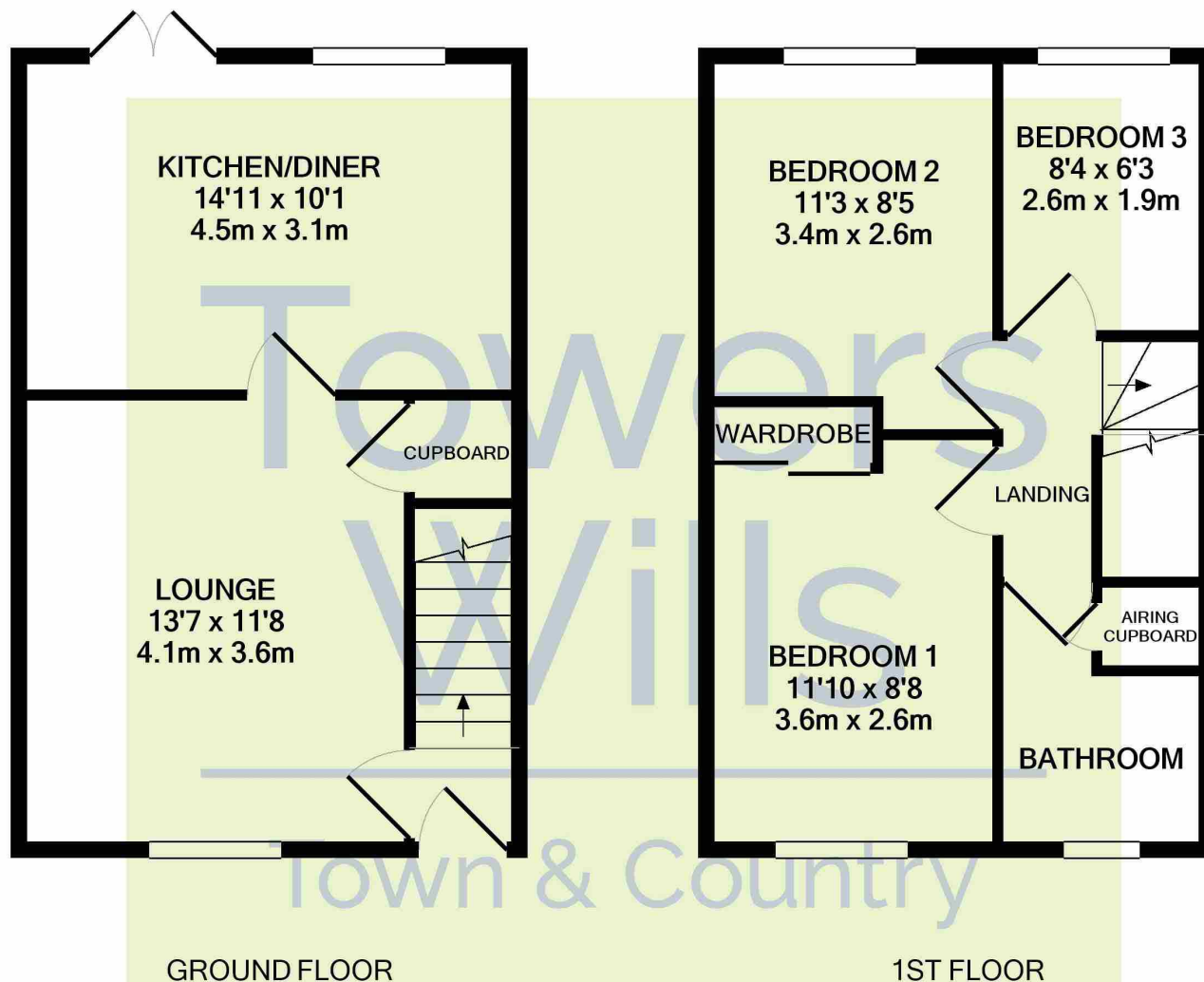

Whilst every attempt has been made to ensure the accuracy of the floor plan contained here, measurements of doors, windows, rooms and any other items are approximate and no responsibility is taken for any error, omission, or mis-statement. This plan is for illustrative purposes only and should be used as such by any prospective purchaser. The services, systems and appliances shown have not been tested and no guarantee as to their operability or efficiency can be given  
Made with Metropix ©2021

Please Note No tests have been undertaken of any of the services and any intending purchasers should satisfy themselves in this regard. Towers Wills Ltd for themselves and for the vendor of this property whose agents they are, give notice that, (i) these particulars do not constitute any part of an offer or contract, (ii) all statements contained within these particulars are made without responsibility on the part of Towers Wills or the vendor, (iii) whilst made in good faith, none of the statements contained within these particulars are to be relied upon as a statement of representation or fact, (iv) any intending purchaser must satisfy him/herself by inspection or otherwise as to the correctness of each of the statements contained within these particulars, (v) the vendor does not make or give either Towers Wills or any person in their employment any authority to make or give representation or warranty whatsoever in relation to this property.

Photographs / Floor Plans Photographs are reproduced for general information and it must not be inferred that any item is included for sale with this property. Please note floor plans are not to scale and are for identification purposes only. The photographs used in these particulars may have been taken with the use of a wide angle lens. If you have any queries as to the size of the accommodation or plot, please address these with the agent prior to making an appointment to view

**Towers Wills**

The White House, 114 Hendford Hill, Yeovil BA20 2RF

Yeovil 01935 577032 / South Petherton 01460 298530

[info@towerswills.co.uk](mailto:info@towerswills.co.uk) | [www.towerswills.co.uk](http://www.towerswills.co.uk)