

# Towers Wills

Town & Country

📞 01935 577 032 | 01460 298 530 | ✉ info@towerswills.co.uk



**33, Tintagel Road, Yeovil, Somerset BA21 3RE**

**OIEO £180,000**

Selling with no onward chain, this is an ideal first time buy or buy to let! This end of terrace sits in a quiet cul-de-sac in a sought-after location and benefits from a good-sized open plan lounge/diner, kitchen, rear porch, enclosed rear garden, three bedrooms and family bathroom. Please contact Towers Wills to arrange a viewing on 01935 577032.

### Entrance Hall

Double glazed door to the front, radiator and cupboard.

### Lounge Diner 4.50m x 5.96m - maximum measurements

Two radiators, TV point, double glazed window to the rear and glazed door leading to rear porch.

### Rear Porch

Double glazed window to the rear and double glazed door leading to the rear garden.

### Kitchen 2.50m x 2.66m - maximum measurements

Comprising of a range of wall, base and drawer units, work surfacing with stainless steel sink drainer with one bowl, double glazed window to the front, cooker (hob and oven), space for fridge freezer, space for dishwasher and washing machine.

### First Floor Landing

Airing cupboard including gas central heating boiler, additional cupboard and loft hatch.

### Bedroom One 2.57m x 4.43m - maximum measurements

Radiator, double glazed windows to the rear and side and built-in wardrobe.

### Bedroom Two 2.08m x 3.36m

Radiator and double glazed window to the front.

### Bedroom Three 3.35m x 1.85m

Radiator and double glazed window to the rear.

### Bathroom

Suite comprising bath with electric shower over, wash hand basin, w.c, double glazed window to the front and radiator.

### Outside/ Front Garden

To the front of the property there is an outside tap and lawn area.

### Rear Garden

The rear garden is largely decked with a rear gate and gravel beds.

## Key Features

- Three bedrooms
- Popular residential location
- Enclosed Rear Garden
- Well presented throughout
- Quiet position

## Contact Us

### Towers Wills Estate Agents - Yeovil

114, Hendford Hill

Yeovil

Somerset

BA202RF

T: 01935 577032

E: [info@towerswills.co.uk](mailto:info@towerswills.co.uk)





# Floor Plan

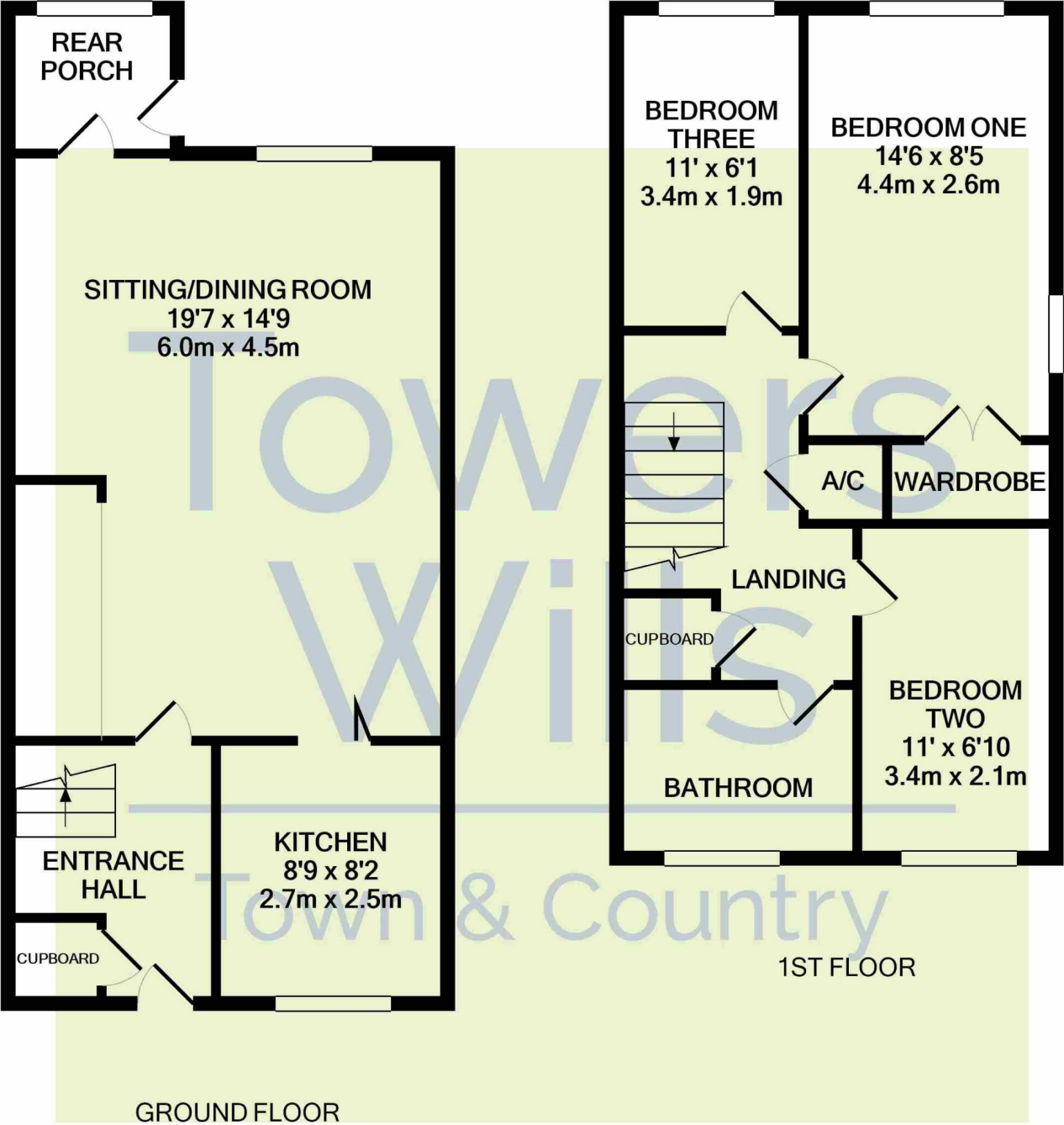

Whilst every attempt has been made to ensure the accuracy of the floor plan contained here, measurements of doors, windows, rooms and any other items are approximate and no responsibility is taken for any error, omission, or mis-statement. This plan is for illustrative purposes only and should be used as such by any prospective purchaser. The services, systems and appliances shown have not been tested and no guarantee as to their operability or efficiency can be given  
Made with Metropix ©2021

Please Note No tests have been undertaken of any of the services and any intending purchasers should satisfy themselves in this regard. Towers Wills Ltd for themselves and for the vendor of this property whose agents they are, give notice that, (i) these particulars do not constitute any part of an offer or contract, (ii) all statements contained within these particulars are made without responsibility on the part of Towers Wills or the vendor, (iii) whilst made in good faith, none of the statements contained within these particulars are to be relied upon as a statement of representation or fact, (iv) any intending purchaser must satisfy him/herself by inspection or otherwise as to the correctness of each of the statements contained within these particulars. (v) the vendor does not make or give either Towers Wills or any

**Towers Wills**

The White House, 114 Hendford Hill, Yeovil BA20 2RF

Yeovil 01935 577032 / South Petherton 01460 298530

[info@towerswills.co.uk](mailto:info@towerswills.co.uk) | [www.towerswills.co.uk](http://www.towerswills.co.uk)