

# Towers Wills

Town & Country

📞 01935 577 032 | 01460 298 530 | ✉ info@towerswills.co.uk



**6, Westland Road, Yeovil, Somerset BA20 2AS**

**£190,000**

Towers Wills are pleased to bring to market this two double bedroom end terrace property situated on the West side of Yeovil close to local school's and amenities. The property benefits from lounge, dining room, kitchen, family bathroom, off road parking, downstairs cloakroom and front and rear garden.

**Lounge** (3.34m x 4.60m)

Front aspect window, wood effect flooring, radiator, and storage cupboard.

**Dining Room** (3.39m x 2.86m)

Wood effect flooring, storage cupboard, radiator with window to the side.

**Kitchen** (5.26m x 1.32m)

Wood effect flooring, window to the rear, tiled splash backs, roll top work surfaces, downlighters, space for cooker, space for washing machine, space for fridge/freezer and door to the rear leading out to the lean to.

**Lean To** (3.14m x 1.57m)

Double glazed door to the garden, window, downstairs cloakroom is fitted with a WC, wash hand basin.

**Bedroom One** (2.75m x 4.63m)

Carpeted with two front aspect windows, built in cupboard, radiator and a built in wardrobe.

**Bedroom Two** (3.08m x 2.85m)

Carpeted, two built in wardrobes, radiator, and a window to the rear.

**Family Bathroom** (3.02m x 2.27m)

Wood effect flooring, bath with shower over, wash hand basin, WC, cupboard housing boiler and window to the rear.

**Gardens**

To the front and side of the property is a garden area with wood chippings and mature shrubs. There is a gravel area, car port and garage. The rear garden is mainly laid to lawn with a small patio area. In the rear garden there is a wooden shed and wooden summerhouse.

## Key Features

- End of Terrace
- Two Bedrooms
- Off Road Parking
- Front & Rear Gardens

## Contact Us

**Towers Wills Estate  
Agents - Yeovil**

114, Hendford Hill

Yeovil

Somerset

BA202RF

T: 01935 577032

E: [info@towerswills.co.uk](mailto:info@towerswills.co.uk)





# Floor Plan

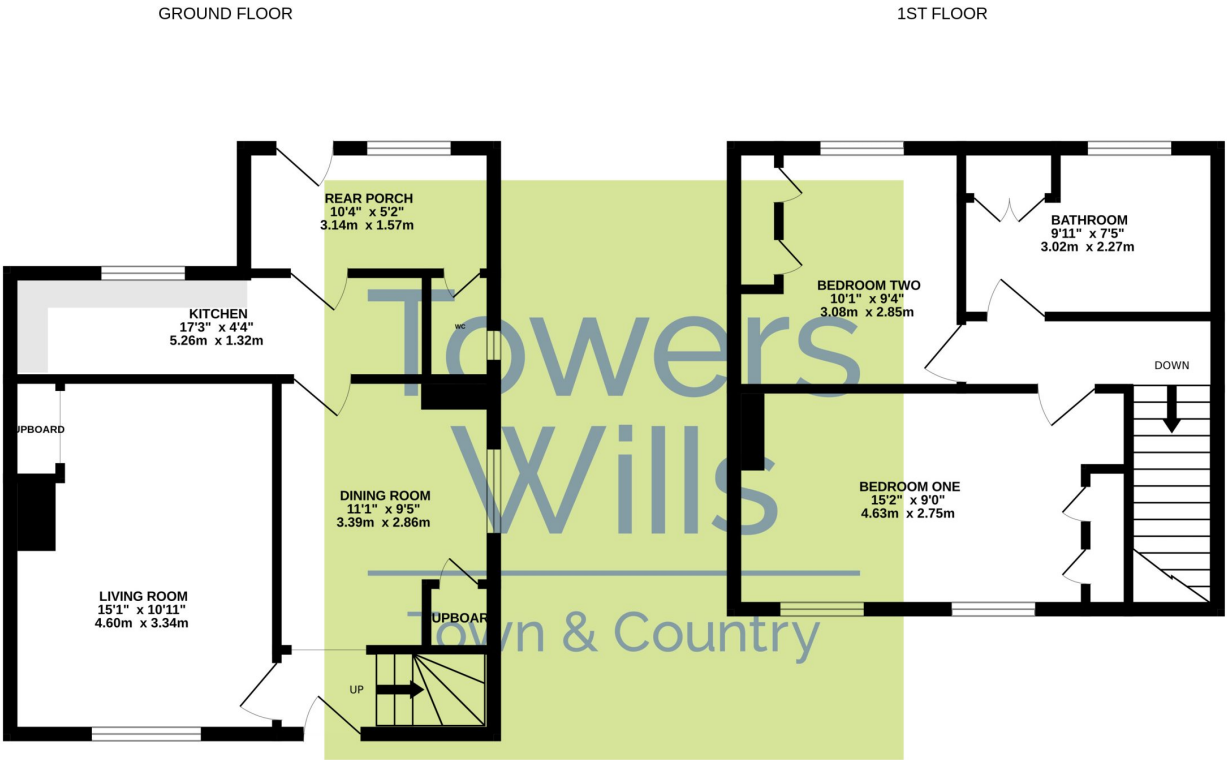

Whilst every attempt has been made to ensure the accuracy of the floorplan contained here, measurements of doors, windows, rooms and any other items are approximate and no responsibility is taken for any error, omission or mis-statement. This plan is for illustrative purposes only and should be used as such by any prospective purchaser. The services, systems and appliances shown have not been tested and no guarantee as to their operability or efficiency can be given.  
Made with Metropix ©2023

Please Note No tests have been undertaken of any of the services and any intending purchasers should satisfy themselves in this regard. Towers Wills Ltd for themselves and for the vendor of this property whose agents they are, give notice that, (i) these particulars do not constitute any part of an offer or contract, (ii) all statements contained within these particulars are made without responsibility on the part of Towers Wills or the vendor , (iii) whilst made in good faith, none of the statements contained within these particulars are to be relied upon as a statement of representation or fact , (iv) any intending purchaser must satisfy him/herself by inspection or otherwise as to the correctness of each of the statements contained within these particulars, (v) the vendor does not make or give either Towers Wills or any person in their employment any authority to make or give representation or warranty whatsoever in relation to this property.

Photographs / Floor Plans Photographs are reproduced for general information and it must not be inferred that any item is included for sale with this property. Please note floor plans are not to scale and are for identification purposes only. The photographs used in these particulars may have been taken with the use of a wide angle lens. If you have any queries as to the size of the accommodation or plot, please address these with the agent prior to making an appointment to view

**Towers Wills**

The White House, 114 Hendford Hill, Yeovil BA20 2RF

Yeovil 01935 577032 / South Petherton 01460 298530

[info@towerswills.co.uk](mailto:info@towerswills.co.uk) | [www.towerswills.co.uk](http://www.towerswills.co.uk)