



Windrush, Westbury, Bradford Abbas, Dorset DT9 6RJ

£279,000

Towers Wills welcome to the market this substantial three bedroom semi-detached bungalow situated in this sought after village. The property requires modernisation and offers tremendous potential for further extensions (subject to planning permissions) and briefly comprising: reception hallway, living room, dining room, kitchen, three bedrooms, bathroom, large garage/workshop, driveway and large rear garden.

Reception Hallway

Door to the front and airing cupboard.

Living Room

With open fireplace, radiator and being open plan to the dining room.

Dining Room

With pleasant outlook onto the rear garden, patio doors to the rear garden and radiator.

Kitchen

Comprising of wall, base and drawer units, work surfacing with inset sink / drainer, space for fridge / freezer, window to the front.

Bedroom One

With built-in wardrobes, window to the rear and radiator.

Bedroom Two

With window to the front and radiator.

Bedroom Three

With window to the rear and radiator.

Bathroom

Suite comprising of bath with shower over, wash hand basin, w.c, part tiled, radiator and window to the front.

Garage/Workshop 8.80m x 4.60m

A large garage/workshop area with barn style doors to the front, plumbing for washing machine, windows to both front and side and door to the rear garden.

Driveway

Providing off road parking for several vehicles.

Rear Garden

The rear garden is majority laid to lawn with well stocked borders, stocked with a variety of mature trees, plants and shrubs. The large rear garden is one of the property's true selling features.

Key Features

- Sought after village
- Three bedrooms
- Large living space
- Tremendous potential
- Large garage / Workshop
- Requiring modernisation
- No onward chain

Contact Us

Towers Wills Estate Agents - Yeovil

114, Hendford Hill
Yeovil

Somerset

BA202RF

T: 01935 577032

E: info@towerswills.co.uk



Floor Plan

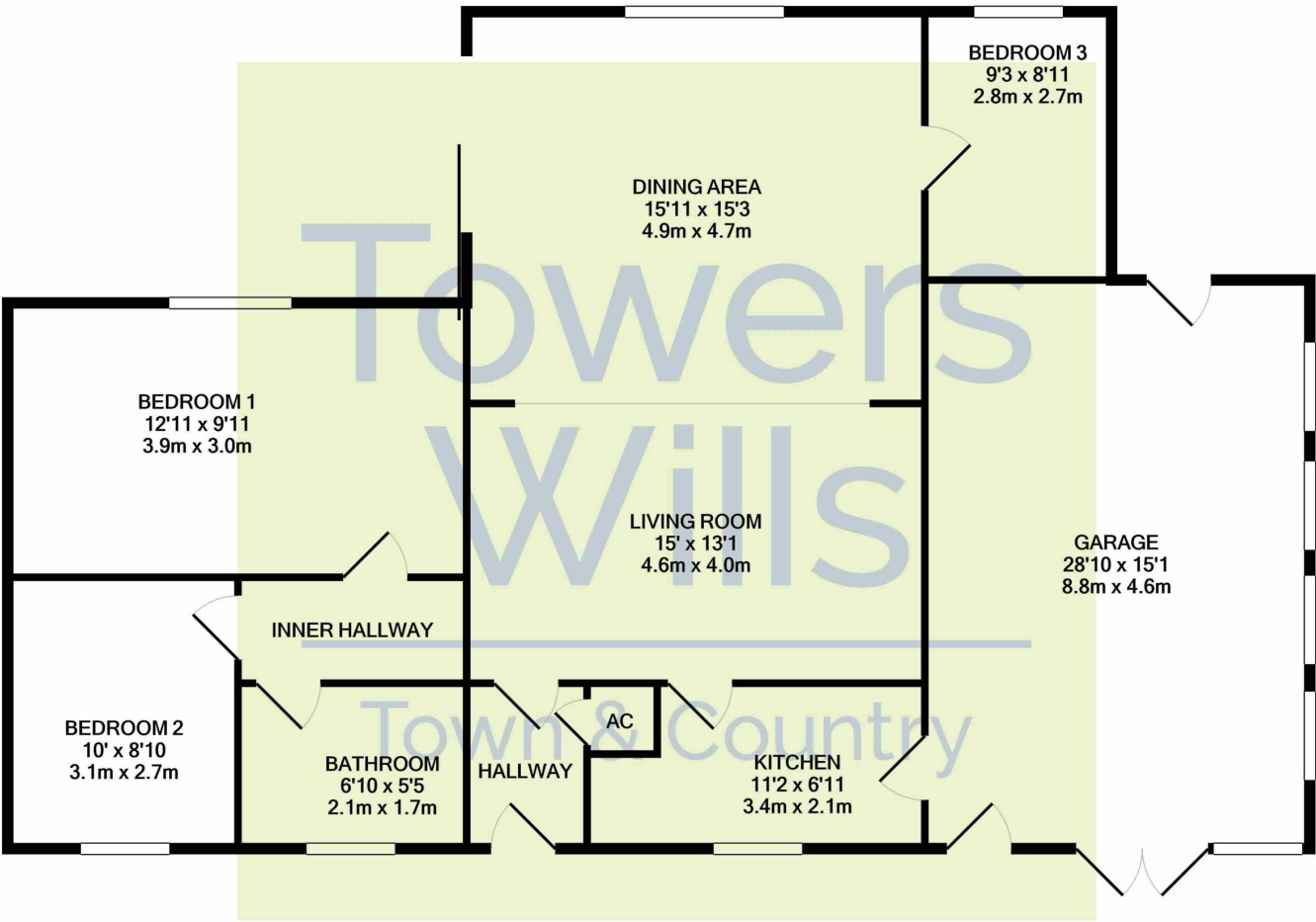

Whilst every attempt has been made to ensure the accuracy of the floor plan contained here, measurements of doors, windows, rooms and any other items are approximate and no responsibility is taken for any error, omission, or mis-statement. This plan is for illustrative purposes only and should be used as such by any prospective purchaser. The services, systems and appliances shown have not been tested and no guarantee as to their operability or efficiency can be given
Made with Metropix ©2021

Please Note No tests have been undertaken of any of the services and any intending purchasers should satisfy themselves in this regard. Towers Wills Ltd for themselves and for the vendor of this property whose agents they are, give notice that, (i) these particulars do not constitute any part of an offer or contract, (ii) all statements contained within these particulars are made without responsibility on the part of Towers Wills or the vendor , (iii) whilst made in good faith, none of the statements contained within these particulars are to be relied upon as a statement of representation or fact , (iv) any intending purchaser must satisfy him/herself by inspection or otherwise as to the correctness of each of the statements contained within these particulars, (v) the vendor does not make or give either Towers Wills or any person in their employment any authority to make or give representation or warranty whatsoever in relation to this property.

Photographs / Floor Plans Photographs are reproduced for general information and it must not be inferred that any item is included for sale with this property. Please note floor plans are not to scale and are for identification purposes only. The photographs used in these particulars may have been taken with the use of a wide angle lens. If you have any queries as to the size of the accommodation or plot, please address these with the agent prior to making an appointment to view