

Towers Wills

Town & Country

📞 01935 577 032 | 01460 298 530 | ✉ info@towerswills.co.uk



12, Woodcote, Yeovil, Somerset BA20 2SE

£210,000

Towers Wills are pleased to present to the market this beautifully maintained two-bedroom mid-terrace home, situated in a popular residential location on the edge of Yeovil, offering convenient access to local commuter routes, amenities and the town centre.

Accommodation:

Presented in very good condition throughout, this attractive property offers well-proportioned accommodation ideally suited to a range of purchasers, including first-time buyers, downsizers and investors alike.

The accommodation begins with an inviting entrance hallway providing access to a well-appointed kitchen, fitted with a range of wall and base units. From the hallway, there is further access to a generous lounge/dining room, creating an excellent space for both relaxing and entertaining. Double doors open directly onto the rear garden, allowing plenty of natural light to flow through the room.

To the first floor are two generous double bedrooms, one of which benefits from a useful built-in storage cupboard. Both bedrooms are served by a modern family bathroom fitted with a contemporary suite.

Outside:

To the front of the property is an enclosed lawned garden bordered by timber fencing and accessed via a picket gate leading to the front entrance. A particular feature of the property is the nearby single garage, together with parking directly in front providing off-road parking for one vehicle.

Outside, the rear garden enjoys a pleasant and private aspect, being predominantly laid to raised decking with a small lawned area, complemented by mature shrubs and planting. The garden also benefits from gated rear access.

An internal viewing is highly recommended to fully appreciate the quality of accommodation on offer and the excellent position of this superb home.

Key Features

- Terraced House
- Two Bedrooms
- Popular Location
- Off Road Parking & Garage
- Garden

Contact Us

**Towers Wills Estate
Agents - Yeovil**

114, Hendford Hill

Yeovil

Somerset

BA202RF

T: 01935 577032

E: info@towerswills.co.uk



Floor Plan

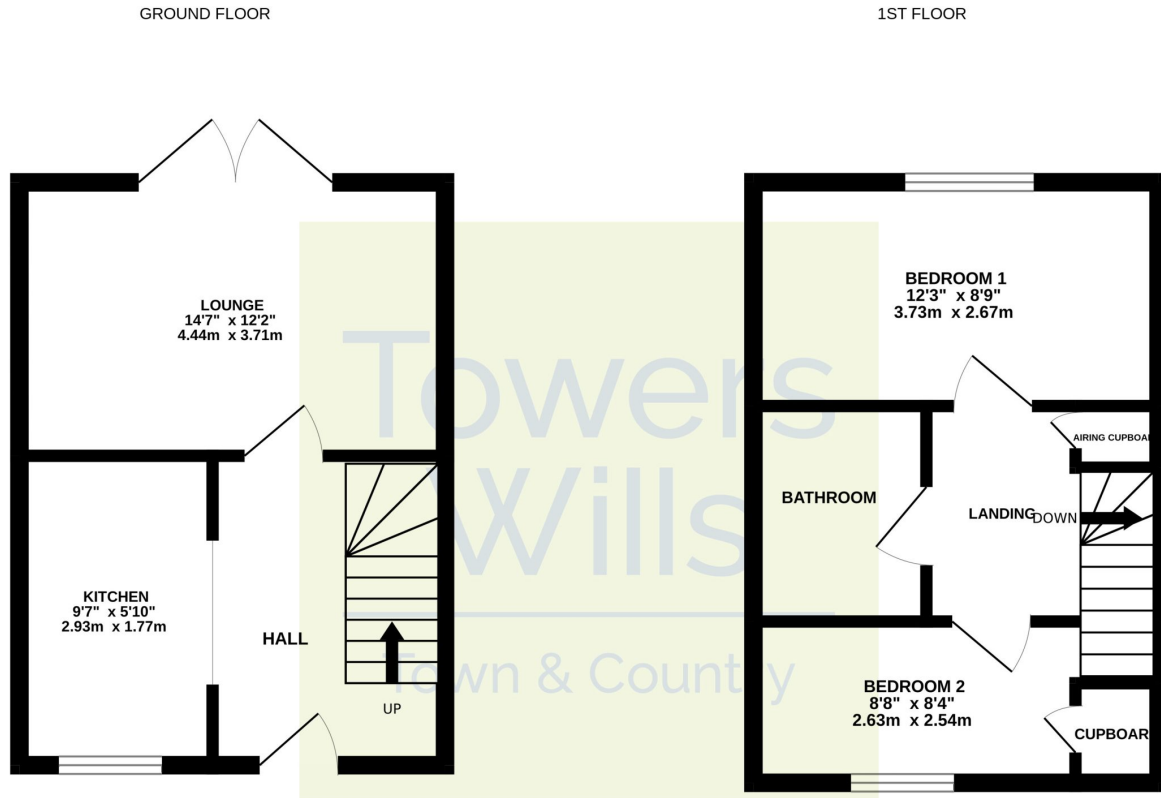

Whilst every attempt has been made to ensure the accuracy of the floorplan contained here, measurements of doors, windows, rooms and any other items are approximate and no responsibility is taken for any error, omission or mis-statement. This plan is for illustrative purposes only and should be used as such by any prospective purchaser. The services, systems and appliances shown have not been tested and no guarantee as to their operability or efficiency can be given.
Made with Metropix ©2026

Please Note No tests have been undertaken of any of the services and any intending purchasers should satisfy themselves in this regard. Towers Wills Ltd for themselves and for the vendor of this property whose agents they are, give notice that, (i) these particulars do not constitute any part of an offer or contract, (ii) all statements contained within these particulars are made without responsibility on the part of Towers Wills or the vendor, (iii) whilst made in good faith, none of the statements contained within these particulars are to be relied upon as a statement of representation or fact, (iv) any intending purchaser must satisfy him/herself by inspection or otherwise as to the correctness of each of the statements contained within these particulars, (v) the vendor does not make or give either Towers Wills or any person in their employment any authority to make or give representation or warranty whatsoever in relation to this property.

Photographs / Floor Plans Photographs are reproduced for general information and it must not be inferred that any item is included for sale with this property. Please note floor plans are not to scale and are for identification purposes only. The photographs used in these particulars may have been taken with the use of a wide angle lens. If you have any queries as to the size of the accommodation or plot, please address these with the agent prior to making an appointment to view

Towers Wills

The White House, 114 Hendford Hill, Yeovil BA20 2RF

Yeovil 01935 577032 / South Petherton 01460 298530

info@towerswills.co.uk | www.towerswills.co.uk